



S500 Drill Stand

Sep. 2024

Internal & Confidential

AGP TAIWAN

Lee Yeong Industrial Co., Ltd.
No.2, Kejia Rd., Douliu City, 64057, Taiwan
Tel : 886-5-5518689 Fax : 886-5-5518635

AGP EUROPE BV

Evenbroekveld 16D, 9420 Erpe-Mere, Belgium
Tel : +32 53 21 62 22 Fax : +32 53 83 88 20



Sales Arguments

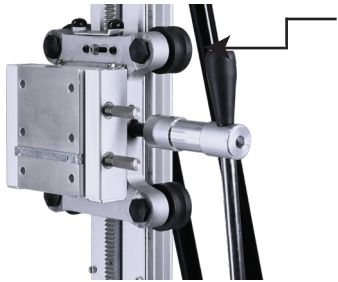

Roller Carriage Guidance
V-groove type low-friction and zero backlash roller guidance with eccentric adjustment.



Built-In Gear Reduction
Both 1:1 and 3.5:1 reduction gearing. Use the 1:1 spindle for fast motion and for small bits. Use the 3.5:1 reduction spindle for decreased operator effort with large bits or when pulling out cores.



Steel Box Section Base
The heavy duty steel base gives reliable stability with large diameters. The built-in wheels assist in movement around the job site.



Steel-Reinforced Aluminum Column
Only the wearing surfaces, (the gear rack and roller tracks) are steel, for maximum strength and manageable weight.



M12 Control Elements
For the convenience of the operator, all control elements on the stand are M12 head, and the crank handle can also be used as a wrench for these.



Technical Specifications

Model	S500
Capacity (with spacers)	500 mm (20")
Capacity (w/o spacers)	350 mm (14")
Effective Stroke (mm)	690 mm (27")
Dimensions (LxWxH)	480 x 240 x 1025 mm
Weight	19.1 kg (42 lb)

- 1 Column
- 2 Carriage Lock
- 3 Carriage
- 4 Motor Mount
- 5 1:1 Crank Spindle
- 6 3.5:1 Ratio Crank Spindle
- 7 Leveling Screws
- 8 Steel Base
- 9 Wheels
- 10 Buttress Bars
- 11 Guide Roller
- 12 Crank Spindle
- 13 Cradle Lock (2)
- 14 Tilt Lock
- 15 Tilt Scale

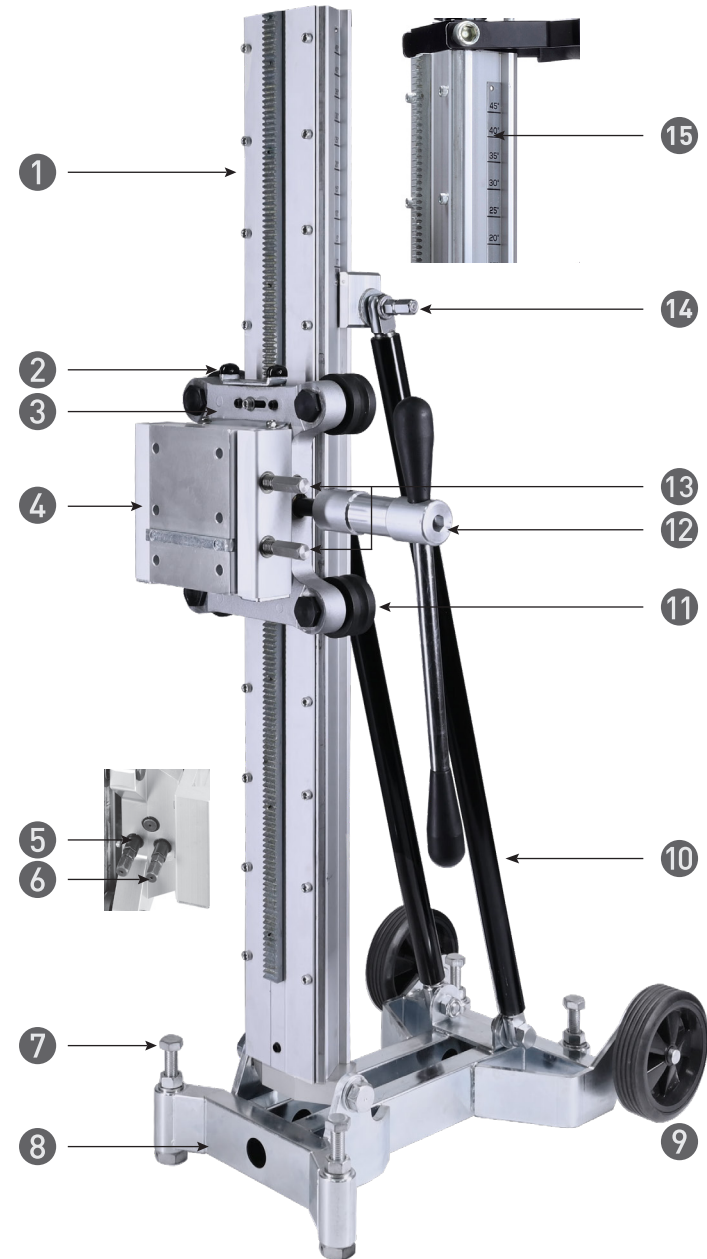

Offer Content

Standard Accessories

- ① S500 Drill Stand
- ② Crank Handle, 2 spoke sliding
- ③ Motor Mount, 6 bolt
- ④ M19 Open End Wrench

Optional Accessory

- ⑤ Anchoring Plate
- ⑥ Fixing Kit, M12 anchors
- ⑦ Top Handle Set
- ⑧ Jack Screw
- ⑨ Modular Extension Spacer, 45 mm(for Ø 450 mm, 18")
- ⑩ Modular Extension Spacer, 100 mm(for Ø 500 mm, 20")
- ⑪ Laser Aiming Device, 1/2" BSP
- ⑫ Laser Aiming Device, 1-1/4" & Ø 60 mm

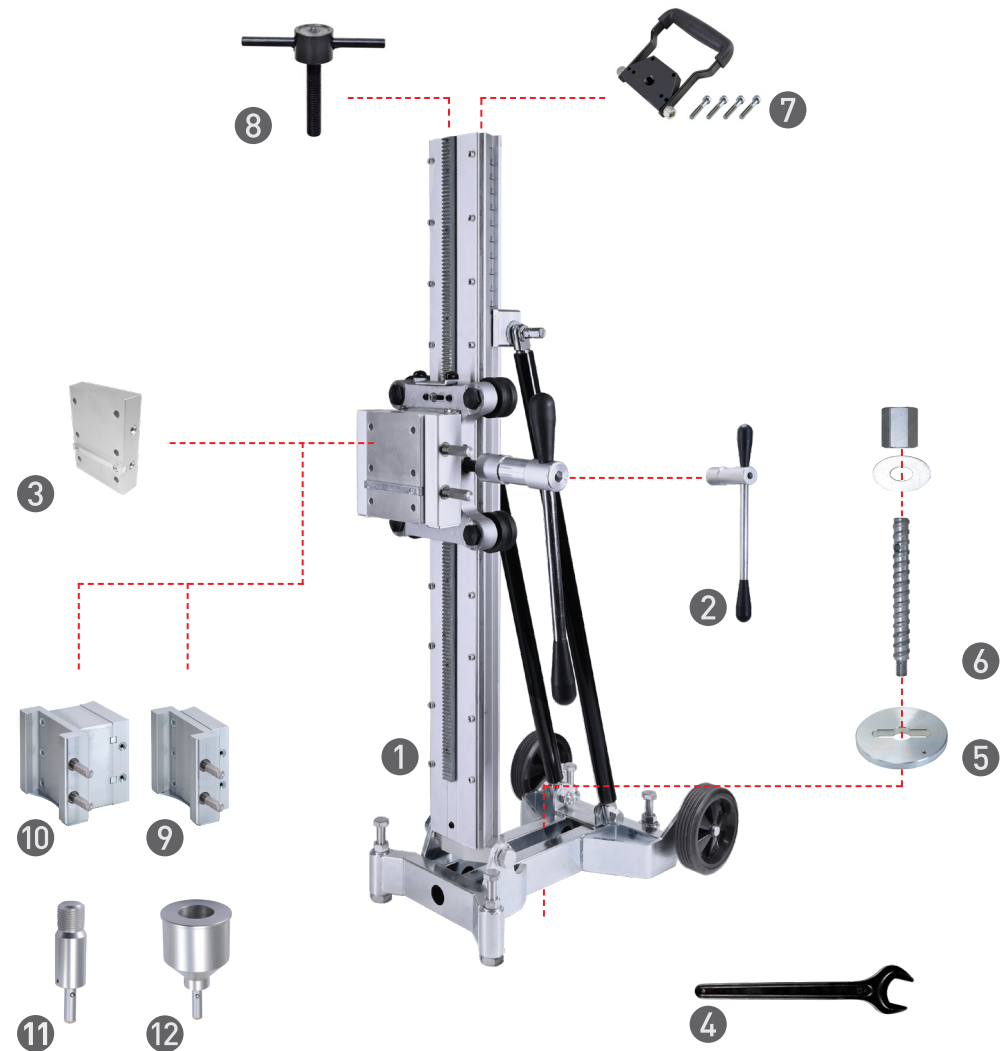

Comparison Table

Brand



500 mm Drill Stands



Model	S500	DD-HD 30 SBP (steel base)	DRA 500	KF 400	DS 500	KS 50 S
Ø Capacity w/o spacers	350 mm	300 mm	250 mm	400 mm	400 mm	300 mm
Max. Ø Capacity	500 mm	600 mm	500 mm	400 mm	500 mm	500 mm
Max. Bit Length	670 mm	(not listed)	869 mm	690 mm	706 mm	630 mm
Center Indicator	no	no	yes	optional	no	no
Crank Gearing	1:1 (both sides) & 3.5:1 (one side)	1:1 (both sides) & 3:1 (both sides)	1:1 (one side) & 3.5:1 (one side)	1:1 on both sides	1:1 (both sides) no reduction gearing	1:1 (optional reduction gearbox)
Adjustments	all M12 hex head	all 1/2" socket square drive	all M19 hex head	mix of square drive and M19 head	all 1/2" socket square drive	mix of sizes (D shaft & M19)
Crank as Wrench	all elements M12 hex head	possible (1/2" square drive elements)	no	(on square drive elements)	possible (1/2" square drive elements)	no
Crank Type	2 spoke, sliding	3 spoke, fixed	4 spoke sliding	3 spoke, square drive	3 spoke, fixed	3 spoke, fixed
Base	steel box section	steel box section	steel box section	stainless steel box section	aluminum	steel box section
Leveling screws	M12 head (4)	1/2" square drive (3)	M19 head (4)	tool-free type (4)	1/2" square drive (4)	tommy bar type (4)
Butress Bars	steel	aluminum, short	steel	optional	aluminum, short	steel, small
Spirit Levels	no	yes	no	no	vertical only	no
Column Extendable	optional long column version	optional	optional	no	optional	no
Quick Release Cradle	dovetail type	yes (Hilti quick-connect)	yes (Tyrolit ModulDrill)	yes	dovetail type	yes
Carriage Guidance	rollers (4)	rollers (4)	rollers (4)	4 stainless rollers	rollers (4)	sliding pads
Carriage Lock	sliding lock type	lock pin type	lock pin type	yes	lock pin type	screw type
Cable Clip on Carriage	no	yes	no	no	no	no
Handle	optional	no	yes	yes	no	yes
Stand Folds Down	45°	yes	45°	60° front and back	yes	45°
Sighting Laser	optional (mounts to motor)	optional (mounts to column)	no	no	no	no
Wheels	yes	optional	optional	optional	optional	yes
Weight	19.1 kg	36.0 kg	26 kg	26.0 kg	17 kg	21 kg
Dimensions	480 x 240 x 1025 mm	410 x 272 x 1087 mm	454 x 301 x 1182 mm	360 x 250 x 1140 mm	395 x 240 x 1050 mm	H: 1070 mm

Conclusion The AGP S500 offers an excellent range of features for maximum convenience and utility. Fast and slow crank ratios are built into the carriage. The roller guidance offers the best control, completely free of backlash. The box-section steel base gives the best stability while the aluminum column with steel reinforcement allows excellent strength without excessive weight.

Tool Dimensions (mm)

